

**WINFIELD**

# EXTERIOR HPL COMPACT



Hong Kong Winfield Trading Limited  
RM1508, Grand Plaza Second Phase, Hong Kong  
Winfield (Shanghai) Industrial Co., Ltd  
No.561, Sanmen Road, Baoshan District, Shanghai  
香港温菲尔德贸易有限公司  
温菲尔德（上海）实业有限公司

官方网站：[www.hkwinfield.com](http://www.hkwinfield.com)  
全国热线：400-9682-286

温菲尔德 户外抗倍特板  
Winfield (Shanghai) Industrial Co., Ltd

温菲尔德 户外抗倍特板

WINFIELD EXTERIOR COMPACT

# 目录索引

DIRECTORIES

---

产品介绍	-----	PRODUCT INTRODUCTION
特点参数	-----	CHARACTERISTIC PARAMETER
产品组成示意图	-----	PRODUCT COMPOSITION DIAGRAM
产品特点图标	-----	PRODUCT FEATURES ICON
安装指导 (铆钉)	-----	INSTALLATION GUIDE (RIVET)
安装指导 (挂墙)	-----	INSTALLATION GUIDE (WALL CLADDING)
材料对比	-----	MATERIAL CONTRAST
储存示意图	-----	STORAGE DIAGRAM
加工工具	-----	MACHINING TOOL
阴阳角处理	-----	INTERNALAND EXTERNAL CORNER
切割指导	-----	CUTTING INSTRUCTION
留缝处理	-----	SLIT TREATMENT

# WINFIELD EXTERIOR COMPACT

温菲尔德户外板具有色彩丰富、耐撞击、高韧性、抗紫外线、耐候、抗污、易清洁、易加工、可拆卸、易维修等特色，且更因其环保节能而成为建筑外墙、户外家具、户外设施与户外标识等户外空间的理想选材。

温菲尔德户外板色彩多样绚丽、木质纹理浑然天成、质轻致密、裁切造型随心所欲，为追求个性的建筑项目和设计师提供了更为广阔的探索空间。无论是艺术家、设计师还是工程师，温菲尔德户外板都是您表达心中梦想的最佳选择。

WINFIELD EXTERIOR COMPACT has the characteristics of rich colors, impact resistance, high toughness, UV resistance, weather resistance, pollution resistance, easy cleaning, easy processing, detachability, and easy maintenance, etc. Moreover, it has become an ideal material choice for outdoor spaces such as outdoor furniture.

WINFIELD EXTERIOR COMPACT has various colors, natural wood texture, light and compact quality, and arbitrary cutting shape, providing a broader exploration space for architectural fields and designers who pursue individuality. Whether it's an artist, designer or engineer, WINFIELD EXTERIOR COMPACT is the best choice for you to express your dream.

## 标准格式 STANDARD FORMAT

1220X2440(4X8)  
1220X3050(4X10)  
1220X3660(4X12)  
1300X2800(4.3X9)  
1300X3050(4.3X10)

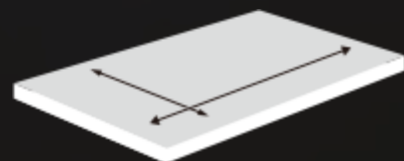

## 标准厚度 STANDARD THICKNESS

6mm=8.76KG/m<sup>3</sup>  
8mm=11.68KG/m<sup>3</sup>  
10mm=14.6KG/m<sup>3</sup>



## 产品介绍

温菲尔德户外板是由装饰色纸含浸树脂，加上多层黑色或褐色牛皮纸含浸酚醛树脂，排叠后，置于 1430psi 及 150°C 高温高压下压制而成，使结构更为紧实及稳定。温菲尔德户外板在芯层外用装饰色纸与高科技 UV 层构成外表面，有高度的抗紫外线辐射能力和良好的耐候性。温菲尔德户外板依其表面色纸层，可满足多种花色选择的装饰需求，具坚固、耐冲击、防水、耐潮湿的特性，因此温菲尔德户外板不但是装饰材料、更是坚固可靠的结构材料，可直接用标准碳钢合金刀具进行钻孔、敲击、砂磨、导型及切割等工作，亦可用 CNC 机具按实际需求切割成任何所需形状，并倒角、钻孔，为兼具实用与装饰的板材。温菲尔德户外板坚固耐候的特殊性质，可运用在各类建筑、外墙及结构材料上，其防潮耐燃特性，可承受恶劣气候环境、侵蚀与冲击，持久不变。符合欧洲 EN438-2 规范，已广泛应用于欧洲市场、非洲市场、中亚市场、南美市场等。温菲尔德户外板是具环保意识的有机材料，制造中使用热循环及再生能源，产品里不含重金属及卤素。温菲尔德户外板是能提升建筑物能源效率的节能建材，作为通风外墙使用时，冬季时能阻绝热量向外散失，在夏季可防止热量向内传导。

WINFIELD Exterior Compact is made of decorative paper impregnated with resin, plus multilayer black or brown kraft paper impregnated with phenolic resin. After stacking, it is pressed under 1430psi and 150°C high temperature and pressure, making the structure more compact and stable. WINFIELD Exterior Compact is composed of decorative paper and high-tech UV layer outside the core layer, which has high UV radiation resistance and good weather resistance. WINFIELD Exterior Compact, based on its surface color paper layer, can meet the decoration requirements of various designs and colors, with the characteristics of firmness, impact resistance, waterproof and moisture resistance. Therefore, WINFIELD Exterior Compact is not only a decorative material, but also a solid and reliable structural material, which can be directly used for drilling, knocking, sanding, guiding and cutting with standard carbon steel alloy cutters, as well as CNC machines and tools to cut into any required shape according to actual needs, chamfered and drilled, making it a practical and decorative plate. WINFIELD Exterior Compact has strong and weather-resistant properties, which can be applied to all kinds of buildings, external walls and structural materials. It can withstand harsh weather environments, erosion and impact, and remains durable for a long time. In line with European EN438-2 standard, it has been widely used in the European market, African market, Central Asian market, South American market, etc. WINFIELD Exterior Compact is an organic material with environmental awareness. It uses thermal cycle and renewable energy in manufacturing, and the products do not contain heavy metals and halogens. WINFIELD Exterior Compact is an energy-saving building material that can improve the energy efficiency of buildings. When used as an external ventilation wall, it can prevent heat from dissipating outwards in winter and from conducting inward in summer.





WINFIELD  
EXTERIOR COMPACT

# WINFIELD

EXTERIOR COMPACT



# WINFIELD

EXTERIOR COMPACT



# WINFIELD

EXTERIOR COMPACT



**WINFIELD**  
EXTERIOR COMPACT



**WINFIELD**  
EXTERIOR COMPACT



**WINFIELD**  
EXTERIOR COMPACT



**WINFIELD**  
EXTERIOR COMPACT



## WINFIELD 特点参数

# CHARACTERISTIC PARAMETERS

温菲尔德户外板具备优越的物理及化学特性，不仅坚固、耐冲击、抗紫外线、防潮、耐火、抗酸碱、可隔音、绝缘又通风，符合欧洲火灾行为规范EN13501分类B-s1, d0的规定，且无软化、滴出及释出有毒烟雾的疑虑，是维护公共安全最完备又环保安全的外墙装饰材料。加上美观大方、可弯曲、卓越的工艺性以及产品寿命长、易清理等经济实惠的考量，温菲尔德户外板提供工程师及建筑师架构建筑外观最强而有力的解决方案。坚固、耐撞，不仅是装饰材料，更是结构材料，质量轻盈，温菲尔德户外板的整体重量均十分轻盈，密度亦仅为1.46g/cm<sup>3</sup>，不及岩石产品的二分之一，具有卓越的工艺性，可通过钻孔、敲击、砂磨、导形、切割等，创造出任何形体，材质稳定。由于温菲尔德户外板的热胀变动性低，因此能移动的负载承载结构最小、具隔音效果，可作为隔音材料，降低由外部传入的噪音指数。容易安装，材质轻盈、富多样性变化、安装快速而简单，而且在加工后，无需特别处理边缘部分，耐火符合欧洲标准规范EN13501分类B-s1, d0的规定，无软化、滴出及释出有毒烟雾的疑虑。优越的化学特性抗酸碱，可以抵抗一般环境下的弱酸弱碱。绝佳的耐候性：耐潮湿、耐热、抗蛀蚀及细菌、低吸水性；对恶劣气候、阳光、下雨及空气污染具有高抵抗性热绝缘，无热桥效应，具备热传绝缘及通风效果，可防止冬天损耗热量及夏天传导热量。颜色稳定，不易受紫外光照射影响，颜色的损失率极低，即使经过长时间曝露，其变动均在可接受的范围内。经济实惠产品寿命长、恒久耐用、易清理且不需维修，实心无毛细孔，由于表面无孔且具电器绝缘性，因此不易黏着脏物，仅靠下雨即可清除残留的粉尘。美观大方温菲尔德户外板具有多种花色可供挑选，除了多元的素色，也提供广受欢迎的木纹花色，选择多样，让建筑外观不再枯燥、无趣，设计装饰范围广，由第一块板材至最后一块板材均毫无任何差异。

# CHARACTERISTIC PARAMETER

WINFIELD Exterior Compact has superior physical and chemical properties. It is not only solid, impact resistant, UV resistant, moisture proof, fire resistant, acid-base resistant, sound proof, insulated and ventilated, but also in line with the European Code of conduct on fire (EN13501) classification B - S1, D0. It has no doubts about softening, dripping and releasing toxic smoke. It is the most complete and environmentally safe exterior wall decoration material for public safety. In addition, WINFIELD Exterior Compact provides engineers and architects with the most powerful solutions for architectural appearance due to its elegant appearance, bendability, excellent workmanship, long service life and easy cleaning. It is not only a decorative material, but also a structural material. Its quality is light. The overall weight of WINFIELD Exterior Compact is very light, and its density is only 1.46g/cm<sup>3</sup>, less than half of the rock products. It has excellent technology. It can create any shape through drilling, knocking, sanding, guiding, cutting, etc., and the material is stable. Due to the low thermal expansion variability of WINFIELD Exterior Compact, the movable load - bearing structure is the smallest and has sound insulation effect. It can be used as sound insulation material to reduce the noise index introduced from the outside. It is easy to install, light in material, rich in variety, fast and simple in installation, and does not need special treatment for the edge part after processing. The fire resistance meets the requirements of European standard EN13501 classification B - S1, D0, and there is no doubt of softening, dropping and releasing toxic smoke. Superior chemical properties of acid and alkali resistance, can resist the general environment of weak acid and alkali. Excellent weather resistance: resistant to dampness, heat, decay, bacteria and low water absorption; high resistance to thermal insulation, no thermal bridge effect, heat transfer insulation and ventilation effect, which can prevent heat loss in winter and heat transfer in summer. The color is stable, not easy to be affected by UV light, and the loss rate of color is very low. Even after a long time of exposure, the changes are within the acceptable range. Economical products have long service life, long durability, easy to clean and maintenance - free. They are solid and hairless. Because the surface has no holes and electrical insulation, they are not easy to adhere to dirt. Only rain can remove residual dust. Beautiful and generous WINFIELD Exterior Compact has a variety of designs and colors to choose from. In addition to multiple plain colors, it also provides popular wood patterns and colors. With a variety of choices, the building appearance is no longer boring and boring, and the design and decoration range is wide. There is no difference from the first plate to the last plate.

## CHARACTERISTIC PARAMETER 特点参数

特点	测试要求	测试结果	试验方法
密度	1.35KG/M <sup>3</sup>	1.46KG/M <sup>3</sup>	ISO 1183
表面耐磨性	IP:50 REVOLUTIONS	通过	EN438-2:2016 clause10
耐水性	等级5	等级 5	EN438-2:2016 clause14
耐干热性	等级5	等级 5	EN438-2:2016 clause16
耐冲击性	冲击高度2.4米	通过	EN438-2:2016 clause21
抗划伤性	最小3N	>6N	EN438-2:2016 clause25
耐沾污性	IP:50 REVOLUTIONS	通过	EN438-2:2016 clause26
抗香烟灼伤	等级5	等级 5	EN438-2:2016 clause30
耐沸水浸泡	等级4	等级 5	EN438-7 clause4.13.1
耐湿性	≤5.0%	0.47%	EN438-7 clause4.13.2
平整度	长度≤3MM/M	1.7MM	EN438-2:2016
抗紫外线	对比度≥3级	等级 4	EN438-2:2016
	外观≥4级	等级 5	EN438-2:2016
抗人工风化	对比度≥3级	等级 4	EN438-2:2016
	外观≥4级	等级 5	EN438-2:2016

## CHARACTERISTIC PARAMETER 特点参数

CHARACTERISTICS	TESTED REQUIRED	TESTED RESULT	TEST METHOD
DENSITY	1.35KG/M <sup>3</sup>	1.46KG/M <sup>3</sup>	ISO1183
RESISTANCE TO SURFACE WEAR	IP:50 REVOLUTIONS	PASS	EN438-2:2016 clause10
RESISTANCE TO WATER VAPOUR	RATING 5	RATING 5	EN438-2:2016 clause14
RESISTANCE TO DRY HEAT	RATING 5	RATING 5	EN438-2:2016 clause16
RESISTANCE TO IMPACT BY LAGRE	IMPACT HEIGHT 2.4M	PASS	EN438-2:2016 clause21
RESISTANCE TO SCRATCHING	MIN 3N	>6N	EN438-2:2016 clause25
RESISTANCE TO STAINING	IP:50 REVOLUTIONS	PASS	EN438-2:2016 clause26
RESISTANCE TO CIGARETTE BURNS	RATING 5	RATING 5	EN438-2:2016 clause30
RESISTANCE TO IMMERSION IN BOILING WATER	RATING 4	RATING 5	EN438-7 clause4.13.1
RESISTANCE TO WET CONDITIONS	≤5.0%	0.47%	EN438-7 clause4.13.2
FLATNESS	≤3MM/M LENGTH	1.7MM	EN438-2:2016
RESISITANCE TO UV LIGHT	CONTRAST≥RATING 3	RATING 4	EN438-2:2016
	APPEARANCE≥RATING 4	RATING 5	EN438-2:2016
RESISITANCE TO ARTIFICIAL WEATHERING	CONTRAST≥RATING 3	RATING 4	EN438-2:2016
	APPEARANCE≥RATING 4	RATING 5	EN438-2:2016



# 安装指导

INSTALLATION INSTRUCTION

## PRODUCT COMPOSITION DIAGRAM

### 产品组成示意图

- |          |                                   |
|----------|-----------------------------------|
| ① 紫外线防护膜 | ① UV protection flim              |
| ② 装饰层    | ② Decorative layer                |
| ③ 多层牛皮纸  | ③ Multiple layers of kraft papers |
| ④ 装饰层    | ④ Decorative layer                |
| ⑤ 紫外线防护膜 | ⑤ UV protection flim              |

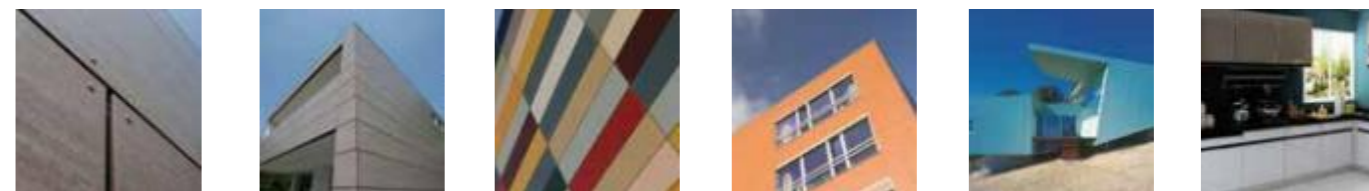
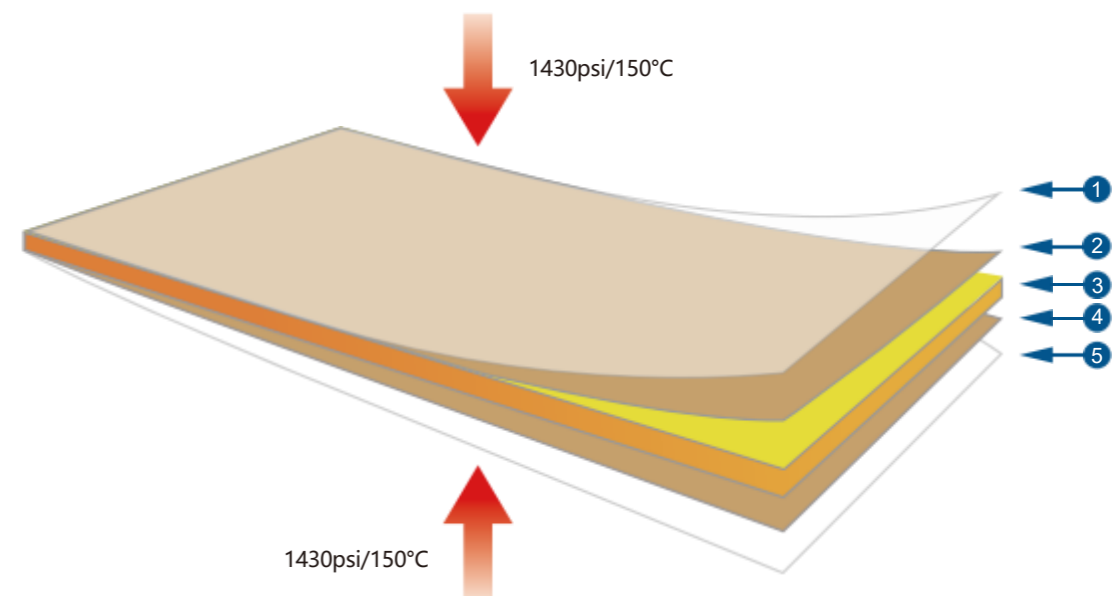

## PRODUCT FEATURE ICON

### 产品特点图标

-  耐水性 WATER RESISTANCE
-  抗冲击性 IMPACT RESISTANCE
-  耐火性 FIRE RESISTANCE
-  抗划耐磨性 SCRATCH & ABRASION RESISTANCE
-  节能环保 ENVIRONMENTAL PROTECTION
-  耐候性 WEATHERABILITY
-  易清洁 EASY TO CLEAN
-  色彩丰富 ULTRA COLOR INTENSITY
-  耐化学性 CHEMICAL RESISTANCE

## INSTALLATION GUIDE (1) (RIVET 铆钉)

### 安装示意图 (1)

- |           |                             |
|-----------|-----------------------------|
| ① 螺丝座     | ① Screw holder              |
| ② 承重墙     | ② Load-bearing wall         |
| ③ 托架      | ③ Bracket                   |
| ④ 热绝体     | ④ Thermal insulator         |
| ⑤ T型支架    | ⑤ T stent                   |
| ⑥ 螺丝      | ⑥ Screw                     |
| ⑦ L型支架    | ⑦ L stent                   |
| ⑧ 铆钉      | ⑧ Rivet                     |
| ⑨ 温菲尔德户外板 | ⑨ WINFIELD exterior compact |

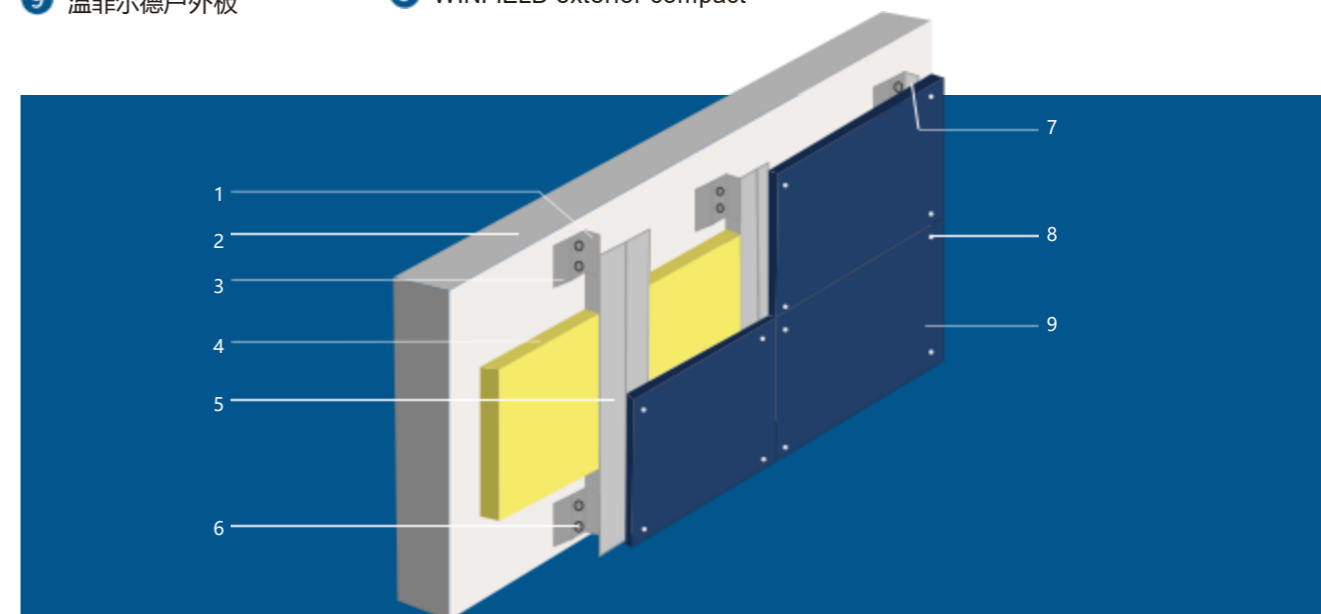

## INSTALLATION GUIDE (2) (RIVET 铆钉)

### 安装示意图 (2)

- |               |           |                              |                             |
|---------------|-----------|------------------------------|-----------------------------|
| ① 承重墙         | ⑪ 温菲尔德户外板 | ① Load-bearing wall          | ⑪ WINFIELD exterior compact |
| ② 保温          | ⑫ 铆钉      | ② Thermal insulation         | ⑫ Rivet                     |
| ③ 空腔:20毫米(最小) |           | ③ Air cavity: 20mm(min.)     |                             |
| ④ 不锈钢螺钉       |           | ④ Stainless steel screw      |                             |
| ⑤ 桥梁支座橡胶垫     |           | ⑤ Bridge bearing rubber pads |                             |
| ⑥ 垂直固定支架      |           | ⑥ Vertical fixing bracket    |                             |
| ⑦ 固定支架        |           | ⑦ Fixing bracket             |                             |
| ⑧ 锚栓/螺钉       |           | ⑧ Anchor bolt / screw        |                             |
| ⑨ 耐候屏障        |           | ⑨ weather resistive barrier  |                             |
| ⑩ 三元乙丙橡胶条     |           | ⑩ EPDM rubber strip          |                             |

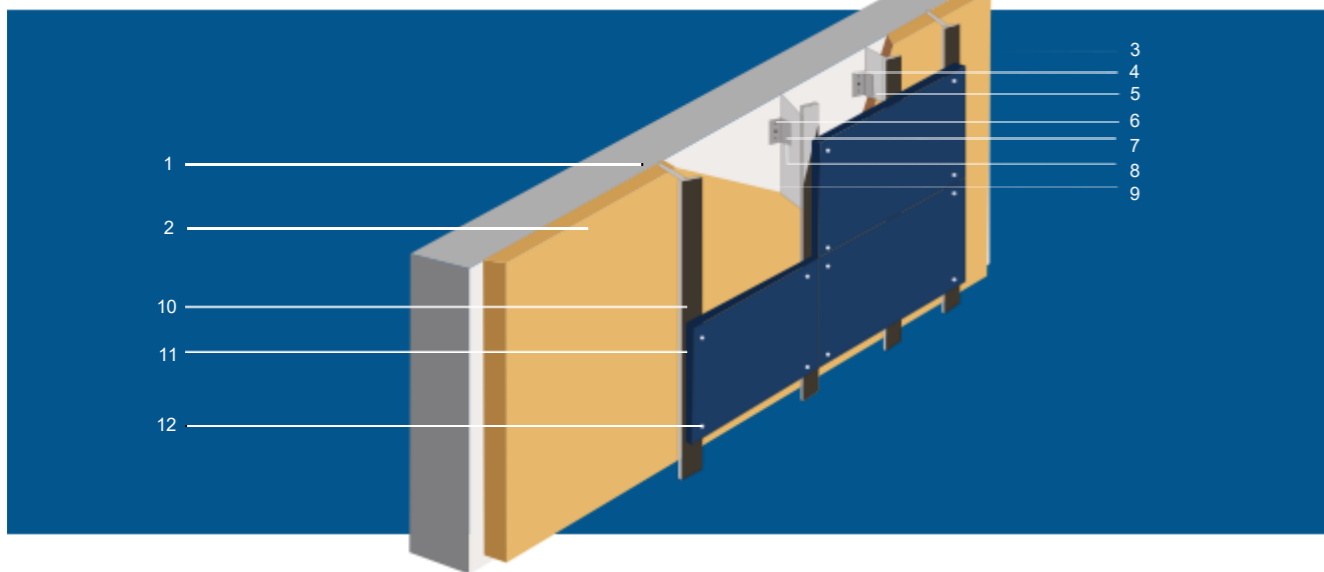

## INSTALLATION GUIDE (3) (WALL CLADDING 干挂)

### 安装示意图 (3)

- |                 |           |                             |                              |
|-----------------|-----------|-----------------------------|------------------------------|
| ① 承重墙           | ⑪ 温菲尔德户外板 | ① Load-bearing wall         | ⑪ WINFIELD exterior compact  |
| ② 空腔: 20毫米 (最小) | ⑫ 桥梁支座橡胶垫 | ② Air cavity: 20mm(min.)    | ⑫ Bridge bearing rubber pads |
| ③ 调节螺钉          | ⑬ 锚栓      | ③ Adjusting screw           | ⑬ Anchor bolt                |
| ④ 钩子            | ⑭ 固定铆钉    | ④ Hook                      | ⑭ Fixing rivet               |
| ⑤ 二级配置文件        | ⑮ 自攻螺钉    | ⑤ Secondary profile         | ⑮ Self-drilling screw        |
| ⑥ 保温            |           | ⑥ Thermal insulation        |                              |
| ⑦ 支撑架           |           | ⑦ Supporting bracket        |                              |
| ⑧ 主配置文件         |           | ⑧ Primary profile           |                              |
| ⑨ 耐候屏障          |           | ⑨ Weather resistive barrier |                              |
| ⑩ 固定螺钉          |           | ⑩ Fixing screw              |                              |

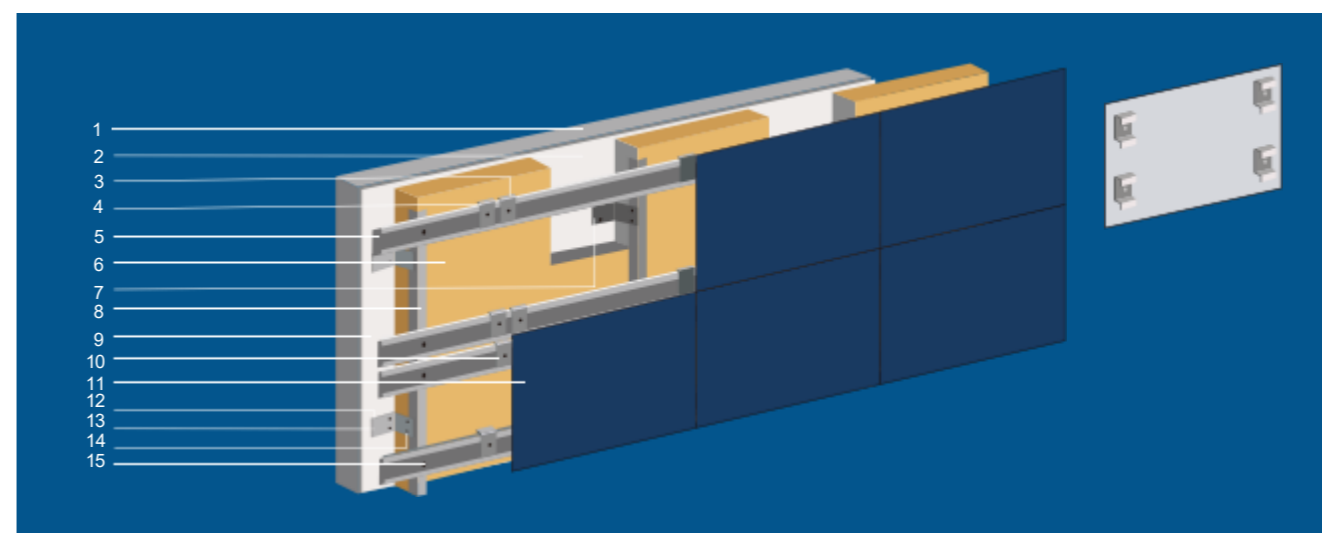

## MATERIAL CONTRAST

### 材料对比

	温菲尔德户外板	石材	玻璃	氟碳烤漆铝板	瓷砖	陶板
色彩	丰富	少	一般	一般	少	一般
色差	不明显	有色差	不明显	不明显	不明显	不明显
抗污性	好	一般	好	一般	一般	好
抗冲击性	好	好	一般	差	差	差
耐磨性	好	好	好	好	好	好
维护成本	低	高	低	低	低	一般
健康环保	优	一般	一般	一般	一般	一般

	WINFIELD EXTERIOR COMPACT	STONE MATERIAL	GLASS	FLUOROCARBON PAINT ALUMINUM PLATE	CERAMIC TILE	POTTERY BOARD
COLOR	RICH	LESS	COMMONLY	COMMONLY	LESS	COMMONLY
CHROMATIC ABERRATION	NOT OBVIOUS	CHROMATIC ABERRATION	NOT OBVIOUS	NOT OBVIOUS	NOT OBVIOUS	NOT OBVIOUS
DIRT RESISTANCE	GOOD	COMMONLY	GOOD	COMMONLY	COMMONLY	GOOD
IMPACT RESISTANCE	GOOD	GOOD	COMMONLY	DIFFERENCE	DIFFERENCE	DIFFERENCE
WEAR RESISTANCE	GOOD	GOOD	GOOD	GOOD	GOOD	GOOD
MAINTENANCE COST	LOW	HIGH	LOW	LOW	LOW	COMMONLY
HEALTH AND ENVIRONMENTAL PROTECTION	EXCELLENT	COMMONLY	COMMONLY	COMMONLY	COMMONLY	COMMONLY

## STORAGE DIAGRAM

### 储存示意图

	<p>绑好安全带'防止雨雪、污垢、阳光直射和其他热源。 Keep strapped and protected from rain, snow, dirt and direct sunlight and other heat sources.</p>
	<p>水平对称堆放(每托盘最多55个单位)'确保通风良好。 store horizontally and symmetrically stacked (maximum of 55units per pallet) . Ensure good ventilation.</p>
	<p>建议储存条件: 20-35摄氏度 45%-65%湿度。 Recommended storage conditions: 20-35degrees celsius 45%-65% humidity.</p>
	<p>使用先进先出法。 use the FIFO method (first in-first out).</p>
	<p>由于板材的尺寸会随天气而变化, 因此在安装/加工前72小时必须对其进行调整。 As the plates can change dimension, depending on the weather, they must be acclimated 72hours before mounting/processing.</p>
	<p>根据 EN438, 请注意 6mm 温菲尔德户外抗倍特板正面板的以下公差: 长/宽 +10mm/-0mm; 厚度 +/-0.4 毫米; 曲率 5.0mm/m; 直角 1.5mm/m。 Please note the following tolerances for 6mm facade panels of WINFIELD compact laminate according to EN438: Length/width +10mm/-0mm; Thickness +/-0.4mm; Curvature 5.0mm/m; Right angle 1.5mm/m .</p>

## MACHINING TOOL

### 储存示意图



## MACHINING TOOL

### 加工工具

<p>1.厚度为6mm时螺丝的最大间距: (a) (2个配件处): 450mm (b) (3个或更多配件处): 550mm</p> <p>1.The maximum distance between screws on WINFIELD plates with a plate thickness of 6mm: (A) (at 2 fittings): 450mm (B) (at 3 or more fittings): 550mm</p>	<p>2. 板材厚度为6mm的板材上, 螺丝孔边缘之间的距离应不小于20mm且不大于60mm</p> <p>2.The distance between the edge of the screw hole shall be minimum 20mm and maximum 60mm on plates with plate thickness of 6mm.</p>	<p>3. 钻芯厚度应为钻头直径的1.5倍以便板材移动。</p> <p>3.The drill thickness shall be 1.5 times the diameter of the drill, so that the plates can move.</p>	<p>4.使用金属钻。</p> <p>4.Use metal drill.</p>

### 注意 ⚠

- 1.搬运和加工时, 建议佩戴防护手套和护目镜。
- 2.加工前或加工过程中, 不要从门面面板表面去除保护膜。同时去除正面面板两侧的保护膜。
- 3.将面板垂直向上提起, 不要将板相互拉。
- 4.面板在使用时应进行运输。

### Be Careful ⚠

1. It is recommended to wear protective gloves and goggles while handling and processing.
2. Do not remove the protective film from the facade panels surfaces before or during the processing. Remove the protective film on both sides of the facade panels simultaneously.
3. Lift the panels straight up and do not haul the plates against each other.
4. Panels should be transported, when they are used.

## MACHINING TOOL

### 加工工具

用于钻温菲尔德 EXTERIOR 板，我们建议使用塑料钻头。钻头的角度必须在 60° - 80° 之间，而不是通常用于钻金 COMPACT 外部面层的 120°。

For drilling WINFIELD exterior compact panels, we recommend the use of drills for plastics. The drills must have a point angle of 60° - 80° instead of the normal 120° that is used for drilling metals.

当钻头接近穿透点时，必须缓慢降低钻头的进给速度并逐渐减小施加的压力，以防止面板背面发生崩裂。此外，为避免崩裂，建议使用完全平整且稳定的垫板（如胶合板或刨花板）。

The feed speed of the drilling head and the pressure being applied must be gently lowered when approaching the point of breakthrough in order to prevent a breakout on the reverse side of the panel. In addition, for preventing breakouts, we recommend the use of a completely flat and stable underlay panel to be used such as plywood or chipboard.

进行盲孔钻削时，需确保孔与面板背面之间保留至少1.5毫米（0.0590英寸）的材料厚度。对于隐蔽固定用途，不建议使用厚度小于8毫米（0.314英寸）的板材。进行边缘钻孔时，建议孔两侧至少各保留3毫米（0.118英寸）的材料。

When blind boring, thought must be given to ensure that 1.5 mm (0.0590") of material remains between the hole and the reverse side of the panel. We do not recommend panels less than 8 mm (0.314") for concealed fixing. When edge drilling, we recommend at least 3 mm (0.118") of material to remain on either side of the hole.

此外，应采用高转速钻孔以避免崩边。为防止崩边和背面崩裂，螺丝安装位置需距板材边缘至少20毫米（0.787英寸）。一般情况下应避免在板材边缘直接安装螺丝；若需在边缘附近安装螺丝，建议螺丝距边缘不小于75毫米（2.952英寸）。

Moreover, a high drilling speed is to be used to avoid chipping. Screws must be positioned no closer than 20 mm (0.787") to an edge in order to avoid chipping and breakouts. Screws into the edges are to be avoided in general. If a screw is to be positioned near an edge, we recommend that they are placed no closer to an edge than 75 mm (2.952").

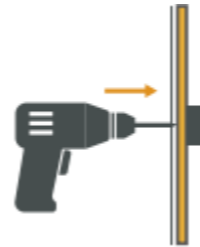
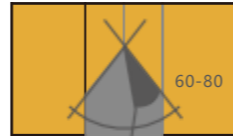

## INTERNAL AND EXTERNAL CORNER TREATMENT

### 阴阳角处理

拐角处应采用铝制拐角型材。

corner shall be completed with a corner profile of aluminum.

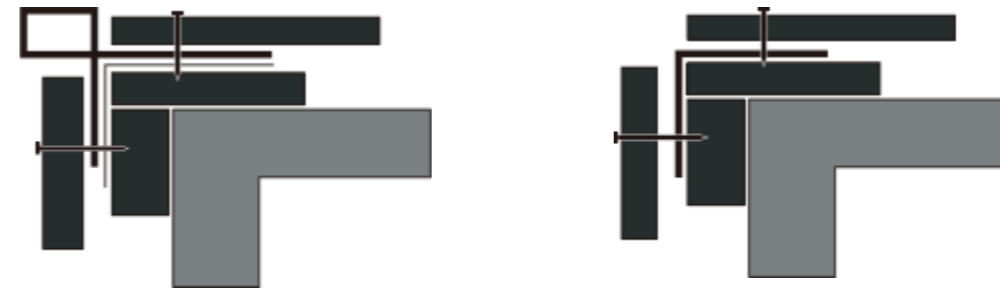

结构拐角处的板材连接可采用开放式接缝或封闭式接缝两种形式。板材厚度为8毫米，足以通过螺丝或铆钉在拐角连接处固定金属角型材。角型材的应用场景为对表面平整度要求较高的项目。

Panel connections at the corners of the structures can be made as both open and closed joints. The panels are 8mm thick, sufficient to secure metal corner profiles with screws or rivets in corner connections. Where the corner profile is used are projects where a smooth surface is desired.

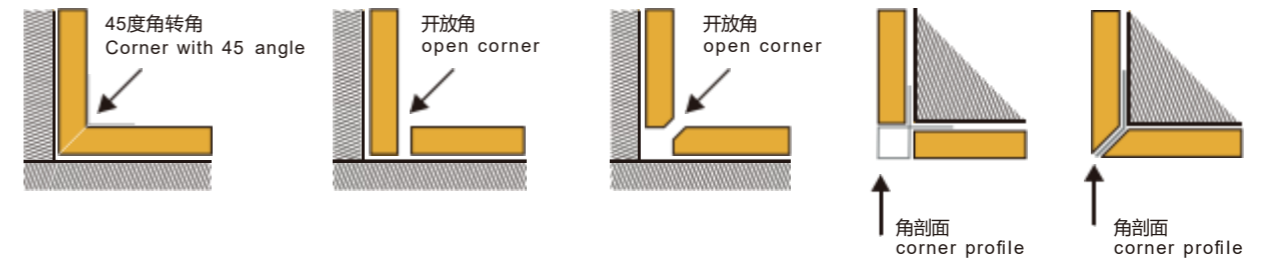

## CUTTING INSTRUCTION ◆

### 加工处理

 <p>150mm 300mm</p>	<p>使用硬质合金锯片 Use the saw blade carbide</p>
	<p>锯的设置必须是精细切割 The saw settings must be fine cuts</p>
 <p>=8-10mm</p>	<p>拐角处的切口约为直径9mm Cut-outs at corners rounded to approximately <math>\phi 9</math></p>
	<p>边缘可以用砂纸或锉刀去毛刺 The edge can be deburred with sandpaper or file</p>

### 注意 ⚠

1. 搬运和加工时，建议佩戴防护手套和护目镜。
2. 加工前或加工过程中，不要从门面面板表面去除保护膜。同时去除正面面板两侧的保护膜。
3. 将面板垂直向上提起，不要将板相互拉。
4. 面板在使用时应进行运输。

### Be Careful ⚠

1. It is recommended to wear protective gloves and goggles while handling and processing.
2. Do not remove the protective film from the facade panels surfaces before or during the processing. Remove the protective film on both sides of the facade panels simultaneously.
3. Lift the panels straight up and do not haul the plates against each other.
4. Panels should be transported, when they are used.

## SLIT TREATMENT ◆

### 留缝处理

1. 接缝：面板应在1米长度内可纵向移动2.5毫米。通过这种设计，预留适当空间以确保面板之间可相互滑动。接缝的最小宽度应至少为面板厚度的一半。此外，接缝必须满足必要的通风和排水需求，以防止因湿气滞留造成损坏。对于宽度超过10毫米的接缝，应在接缝后方设置细格栅系统，以防止碎屑和害虫穿过面板接缝。

1. Joint: The panel shall be assembled in such a way that it moves longitudinally by 2.5mm at 1m. In this way, appropriate space is provided so that the panels can move with each other. The minimum width of the joint shall be at least half the thickness of the panel. In addition, joints must be able to provide the necessary ventilation and drainage to prevent damage due to moisture retention. For joints wider than 10mm, a thin grid system shall be applied behind the joints to prevent flies and vermin from passing through the floor.

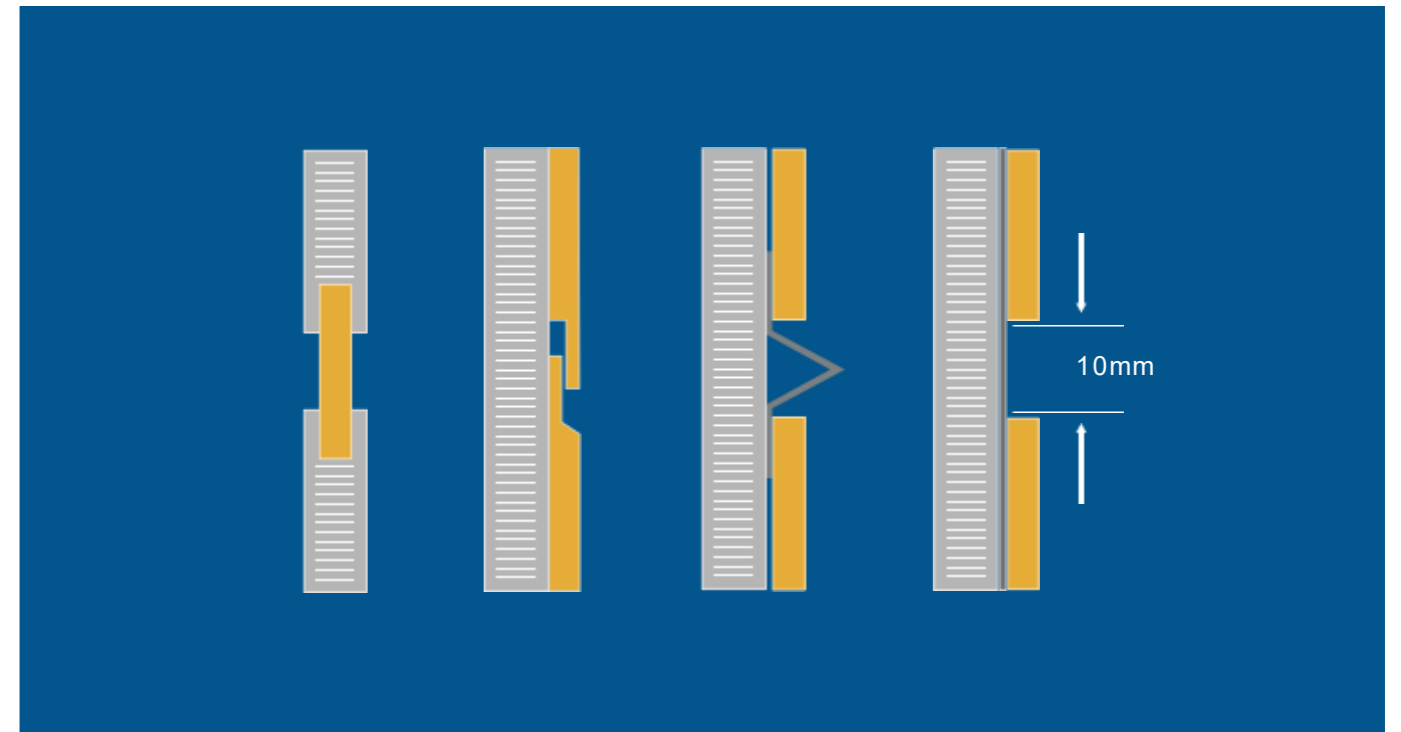

## SLIT TREATMENT ◆

### 留缝处理

开放式接缝：面板连接可采用开放式或填充式。需特别注意：在开放式接缝系统中，垂直和水平接缝可能存在雨水渗透及湿气侵入的风险。当保温材料受潮时，其保温性能会降低。因此需采用防水保温材料，并相应加强下部构造（基层构造）。

2.OPENJOINTS; Panel connections may be open or filled. A Particular attention should be paid against the possibility of infiltrating rain and moisture to vertical and horizontal joints used in open joint systems. When the insulation material is moistened, insulating value drops down below the required standards. Therefore, waterproof insulating material and accordingly the sub-construction is required.

封闭接缝；榫槽接缝与对接缝均属于封闭接缝类型。

CLOSED JOINTS; Tongue-and-groove and halved joints are closed joints.

T型型材；接缝可采用固定式金属、塑料或橡胶型材进行封闭。型材的组装需确保不妨碍面板移动。

T PROFILES; joints can be closed with fixed metal, plastic or rubber profiles. Profile must be assembled in a way that will not avoid the movement of the panels and will work by sliding.

密封胶接缝；密封胶接缝会限制面板移动，并导致面板边缘积聚过多污垢。在填缝应用后，此类接缝绝对不推荐使用。

MASTIC JOINTS; Mastic joints avoid the movement of the panels and cause too much dirt on panel edges. These are definitely not recommended after such joint filling applications.

